



**24TH ANNUAL SCIENTIFIC MEETING OF
THE AUSTRALASIAN COLLEGE OF PHLEBOLOGY
26 - 29 APRIL 2024 | SOFITEL | FIJI**

CONFERENCE HANDBOOK

THE COLLEGE

The Australasian College of Phlebology (ACP) is a modern and progressive society with a young and energetic governance, a comprehensive training program and a dedicated and passionate membership. The ACP organises annual science-driven, dynamic and innovative congresses, workshops and preceptorships.

We are proud to have introduced modern interventional treatment techniques to Australia and New Zealand in the past 25 years including ultrasound guided sclerotherapy (mid-90s), endovenous laser and radiofrequency ablation (early 2000s) and glue ablation (past 5 years).

The ACP was founded in 1993 as the Sclerotherapy Society of Australia by Dr Paul Thibault. In 1999, the Society officially changed name to the Australasian College of Phlebology to coincide with the introduction of its formal training program. Since then, the ACP has established one of the most comprehensive phlebology training programs in the world. Since 1999, the ACP has graduated dozens of venous specialists who now hold teaching, educational and board positions within the College.

The ACP actively promotes education and research in phlebology and serves the general public, governments, insurance providers, regulatory authorities and the industry as a resource regarding venous disorders. The ACP fellowship represents the multi-disciplinary nature of phlebology and includes a variety of medical specialties such as vascular surgery, dermatology, interventional radiology, haematology, vascular medicine and lymphology. Other members of the college include allied health professionals such as sonographers, scientists and nurses with a shared interest in phlebology.

IMPORTANT REMINDERS

- * Speakers ensure you upload your presentation in the speakers prep room well in advance of your talk.
- * Choose your table for the Gala Dinner, place your name on the chart by 2pm Saturday 27 April.
- * Delegates with dietary requirements make your self known to banquet staff.

The Australasian College of Phlebology
Level 5, 7 Help Street
Chatswood, NSW 2067
T: + 61 2 9386 1811
E: acp@phlebology.com.au

EXECUTIVE BOARD

President: Dr Lisa Marks
Immediate Past President: Dr Simon Thibault
Honorary Secretary: Dr David Connor
Treasurer: Dr Paul Thibault
Dr Stephen Benson
Dr Keturah Hoffman
Dr David Huber
Dr Nicholas Kemp
Dr Stuart McMaster
Dr Peter Paraskevas
Prof. Kurosh Parsi
Prof. Neil Piller
Dr Stefania Roberts
Dr Andrew Stirling

ACADEMIC BOARD

Chancellor: Prof. Andre van Rij
Deputy Chancellor: Prof. Lourens Bester
Dean of Education: Dr Andrew Stirling
Director of Training: Dr Lisa Marks
Chief Censor: Dr Niloofar Yazdani Boroujeni

ASM CONVENOR

Dr David Connor

EXECUTIVE MANAGER

Zivka Nicholls

SPONSORSHIP & EXHIBITION

Jan Cornay

WELCOME

Dear Colleagues and Friends,

It is with great pleasure and anticipation that we extend a warm welcome to each one of you to the 24th Annual Scientific Meeting of the Australasian College of Phlebology in the breathtaking and vibrant land of Fiji. As we gather for this prestigious event, set against the backdrop of Fiji's pristine beauty, we embark on a journey of knowledge exchange, collaboration, and innovation.

The next few days promise to be filled with enriching discussions, insightful presentations, and the opportunity to forge meaningful connections with fellow clinicians, researchers, scientists, and professionals from around the world. Together, we will explore the latest advancements, share groundbreaking discoveries, and contribute to the collective pursuit of excellence in our respective fields.

Fiji, with its unique blend of cultural diversity, warm hospitality, and stunning landscapes, serves as an inspiring setting for intellectual exchange. The meeting venue provides a conducive environment for fostering collaboration, sparking new ideas, and creating lasting memories.

We encourage you to actively participate in all the scheduled sessions, engage in lively discussions, and make the most of this platform to expand your knowledge and network. May this Annual Scientific Meeting in Fiji be a catalyst for new friendships, collaborations, and the advancement of scientific endeavours.

We eagerly anticipate your presence at the Conferring Ceremony on Sunday night. Witnessing the remarkable dedication and hard work of our trainees being acknowledged on stage is truly rewarding. We hope you'll join us in congratulating them for this outstanding achievement.

We would like to thank our Sponsors and Exhibitors for their ongoing support. We encourage you to explore their booths, engage with them, and support these exceptional sponsors and exhibitors who have demonstrated dedication to our industry. Their innovative products, services, and contributions have enriched our experience and fostered a vibrant atmosphere for collaboration and knowledge exchange.

Once again, welcome to Fiji! We look forward to a successful and memorable gathering that contributes to the collective progress of science and research in phlebology.

David , Zivka and Jan
Organising Committee
ACP2024



David Connor
Convenor ACP2024



Zivka Nicholls
Executive Manager



Jan Cornay
Event Coordinator

LOCATION

FIJI

Fiji's cluster of heavenly islands is located in the middle of the South Pacific. Scattered across 1,290,000 square kilometres of ocean, it's a tropical paradise of palm-fringed white sand beaches and lush rainforests fringed by thriving coral reefs and fish-filled lagoons.

Roughly one third of the 333 islands are inhabited. Most people live in the urban areas of the two larger islands – Viti Levu & Vanua Levu.

Time Zone

Straddling the 180th Meridian, Fiji is exactly 12 hours ahead of Greenwich Mean Time (GMT). Daylight savings kicks in around November to January, when Fiji moves one more hour ahead.

Climate

There are two seasons here - warm and even warmer! It's a sunny, tropical climate that'll wash the winter chills from your bones.

From December to April, the temperatures are a comfortable 22° - 33°C. But expect May to November to be slightly cooler with temperatures ranging from 19°- 29°C.

People & Language

Fiji's population of more than 880,000 is a melting pot of indigenous Fijians (i-Taukei), Indo-Fijians, Chinese, Part-Europeans and other South Pacific Islanders who call Fiji home. Despite their varied cultural backgrounds, locals are collectively referred to as Fijians.

English is Fiji's official language but you'll often find that most people are bilingual - speaking Fijian or Hindustani as well.

Outside hotels and resorts, people dress modestly - even more so when visiting a Fijian village. It's best to visit one with a tour guide as there are many traditional protocols to be observed.

Key words you will hear and use in Fiji include:

Bula - Is used to greet people or to say hello.

Vinaka - Thank you

Vinaka vakalevu - Thank you very much

Kerekere - Please

Io - Yes [E-ooH]

Sega - No [Se-nga]

Electricity

The local electric current is 240 volts AC 50Hz. Fiji's three-pin power outlets are identical to Australia and New Zealand. Most leading hotels and resorts have universal outlets for 240v or 110v shavers, hair dryers and other electrical appliances.

Tipping

Tipping is not expected but feel free to reward someone for outstanding service.

GETTING AROUND FIJI

BY ROAD

Paved highways encircle the two big islands connecting villages, towns and cities so it's fairly easy to get around.

Hotel and Private Transfers

Most hotels can arrange airport transfers. Some are complimentary while others charge a small fee. Alternatively, you can take the stress out of 'getting there' and pre-book your transfers through local companies.

Bula Bus

The Bula Bus is the only transport you will need to get around Denarau Island between the Port, Hotels, Waterpark and Golf Course. It is a unique open air hop-on hop-off bus service. The cost is \$11 FJD per adult per day or \$35 FJD for a Five Day Pass. Children under 12 travel free with a valid ticket holder.

Taxis

They're an easy option for short trips to Nadi, Denarau and Lautoka. If you flag a taxi off the street, look out for the LT or LH registrations on the license plate. LT plates are metered taxis with a base rate of FJ\$2.50. LH taxis are not metered and have fixed distance rates. Check with your hotel reception about general distances and taxi costs and confirm these with your taxi driver before starting your trip. Before you catch a taxi in Fiji, make sure you have cash (Fiji dollars) for payments and that their taxi metre is turned on.

Car Rentals

Pre-book your rental online with any of the companies at Nadi International Airport. They're located just outside the International Arrivals terminal. All you'll need is a valid driver's license (in English) and a credit card. In Fiji, cars are right hand drives on the left side of the road.

BY AIR

Flying is by far the fastest and easiest way to travel off Viti Levu. Stunning birds-eye views of the islands are just an added bonus! Fiji Link and Northern Air – Fiji's domestic airlines - fly to most small airports around the country. Several companies run charter flights out of Nadi Airport, ready to whisk you away on a scenic helicopter, seaplane or small aircraft.

BY SEA

The most affordable and popular way to see the islands.

Passenger (Resort) Ferries

Escape to the stunning Mamanuca and Yasawa islands with daily connections out of Port Denarau. South Sea Cruises operates these sectors.

Local (Roll on-off Ferries)

If you are cost-conscious, there's always the inter-island ferry to consider. Locals favour this no-frills option for cheap travel between Viti Levu and Vanua Levu. It's also great for self-drives as you're able to take your car onboard with you.

Water Taxis

The Mamanuca and Yasawa islands are some of the most accessible islands in Fiji. If you've missed the regular boat, share a water taxi or charter your own to your resort. Most depart Port Denarau Marina.

THINGS TO DO IN FIJI



GO CRUISING

Get beyond Viti's Levu's sprawling shores and sample the charms of far-flung Fiji on an ocean-going adventure. With 333 islands to explore, there's no better way to visit Fiji's wild places. Hop aboard a sailing ship or catamaran to exotic locales where you can play castaway on a deserted beach, snorkel off an exquisite sand cay or toast the setting sun on a sail around the harbour.



GARDEN OF THE SLEEPING GIANT

This must-see spot is an absolute botanic bonanza. Abloom with more than 2000 varieties of orchids, plus indigenous flora and other tropical beauties, the 20-hectare plantation makes for a gorgeous getaway. Tours are included in the entrance fee, or go on a solo meander along the jungle boardwalk.



SABETO MUD POOL AND HOT SPRINGS

Head to Sabeto for a soothing soak in the area's mud and geothermal pools. The fun, natural spa treatment kicks off with a thick mud lather before washing it all off with a dip in the different thermal pools. You'll feel like a million dollars after – especially if you top it off with a massage from one of the locals.



SRI SIVA SUBRAMANIYA SWAMI TEMPLE

This bright Hindu temple is one of the few places outside India where you can see traditional Dravidian architecture; the wooden carvings of deities travelled here from India, as did the artists who dressed the temple in its colourful coat and impressive ceiling frescos. The inner sanctum is reserved for devotees bringing offerings.



GO ZIPLINING

Check out either of Nadi's two zipline courses for some thrilling treetop adventures. The Sleeping Giant Zip (Sabeto) may have only 5 ziplines but their adventure park packages offer unlimited zips and waterfall tours with lunch. Zip Fiji's (Momi) 16 ziplines entice thrill seekers with longer and higher zips.



EXPLORE THE SIGATOKA RIVER

There are numerous ways to explore the Sigatoka River, whether it be river tubing, rafting, canoeing or taking a high adrenaline jet boat, there is a way to explore for those who want to take it easy and those who want a thrill!

VENUE

SOFITEL FIJI RESORT AND SPA

Sofitel Fiji Resort & Spa is a 5-star retreat where beach resort merges with luxury hotel facilities, surrounded by Fiji's beauty and culture, polished with a touch of French elegance.

There are an array of incredible on-site facilities and experiences for you to enjoy such as Waitui Bar & Grill – the award winning adults' only poolside signature dining experience, SUKA – a vibrant beach rum bar, SOLIS – a beachside Mediterranean seafood restaurant, Niu Kids Beach Club – a stunning children's club on the family side of the resort, Teenage Zone – for 12 to 16 year old guests with a PlayStation & arcade style games, Republik – a late night bar for adults to socialise and dance the night away, and Sofitel Salon – a hair and nail salon located directly within Sofitel Spa.

Sofitel Fitness Center provides holistic, up-to-the-minute wellness programs and classes with the finest cardio machines from Life Fitness. Free weights and state-of-the-art equipment is available for an invigorating full-body workout.

With a prime address on Denarau Island, the resort is a modern and integrated destination which unfolds across 26-acres of lush gardens with views extending across Nadi Bay.

ACCOMMODATION

Every one of Sofitel's 298 luxury rooms and suites face the ocean and set the scene for total relaxation. The resort has an adults only side for travellers that want to savour some peace and quiet away from families.

DINING

Sofitel Fiji presents an abundance of epicurean dining experiences. Uncover elegant interpretations of nouvelle cuisine seamlessly blended with the very best of local flavours. Choose from elegant restaurants, relaxed bars and café-style eateries featuring a rich variety of cuisines. Gastronomy is at the heart of Sofitel and we invite you on a journey to explore our innovative and refined cuisine.

WAITUI BEACH CLUB

The Waitui Beach Club is an adults-only sanctuary located within Sofitel Fiji Resort & Spa. The exclusive Beach Club is well renowned as being a chic spot for you to enjoy the amenities, sip a chilled glass of rosé under the warmth of the sun; sunbathe in style, luxury and comfort.

The ambience of the club makes guests feel at home with luxurious cabanas surrounding the infinity lap pool, lagoon pool and nestled on the beach under the palm trees. Beach Club Access is provided to guests staying within Waitui and Waitui Plus accommodation.

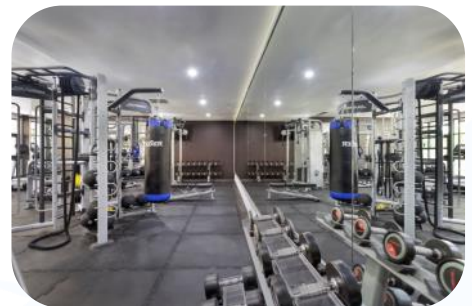

FLOORPLAN

KEY EVENTS

Training Sessions (26, 27 & 28 April)
Ballroom 3 & 4

Ultrasound Workshop (27 April)
Sofitel Ballroom

Ablation Workshop (28 April)
Ballroom 3& 4

Welcome Reception (26 April)
Suka Beachfront

Exhibition and Catering (26-28 April)
Oceanfront Verandah

VIP Ceremony Robing (28 April)
Walu Room (ground floor)

Main Plenary (26-29 April)
Sofitel Ballroom

Speakers Prep (26-29 April)
Republik

Ceremony & Gala Dinner (28 April)
Sofitel Ballroom

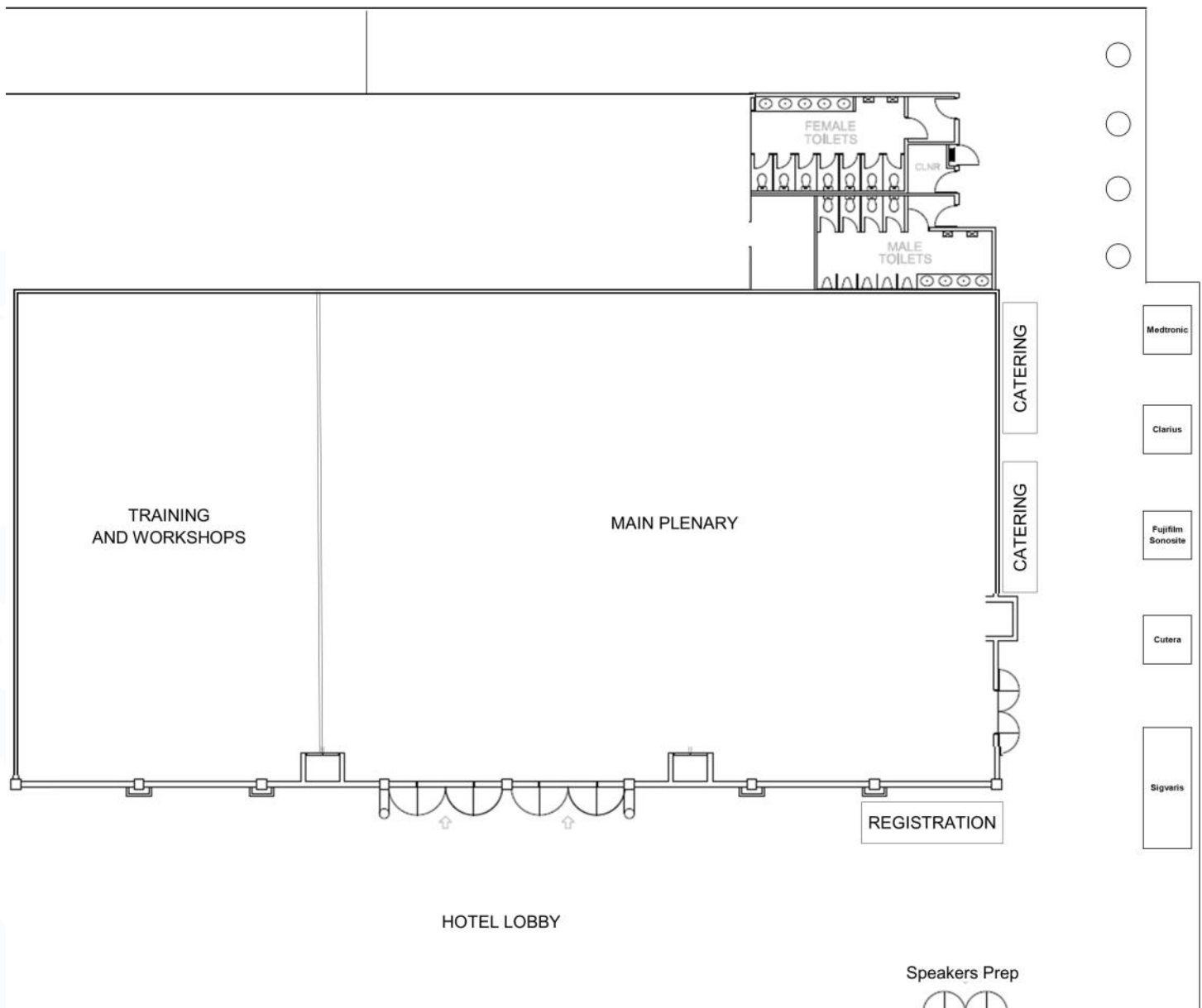

*Floorplan is subject to change

Be Part of Australia's Premier Vein Group





About Vein Doctors Group

Vein Doctors Group is a leading Phlebology group, providing venous services in Gold Coast, Brisbane, Ballina, Toowoomba, Cairns, Mackay, Sydney and Melbourne.

Vein Doctors Group is proud to provide career pathways to trainee Phlebologists, as well as succession pathways to senior doctors to grow the Vein Doctors Group family.

As a growing group, we are currently seeking doctors to work in our clinic locations where there is a high demand for venous services, as well as trainee Phlebologists to work alongside our supervisors to meet this demand.

-  Current locations
-  Proposed locations



Highlights

-  **Rapidly growing Australian Phlebology Group**
-  **Accelerated career opportunities including sub-specialised training in Lipoedema**
-  **Supported by specialist ultrasound service**
-  **Reduced management burden**
-  **Robust compliance and governance infrastructure**

LEARN MORE

Learn about the **career benefits** offered at Vein Doctors Group:



veinclinic.com.au/careers

To discuss opportunities, please call:

- » Leith Coulson, Practice Manager - 0418 181 026
- » Evi Bitran, Operations Manager - 0450 448 170

DELEGATE INFORMATION

SOCIAL EVENTS

Delegates with a full registration receive a complimentary ticket to the Welcome Reception as well as the Conferring Ceremony and Gala Dinner. Additional tickets for guests are available for purchase pending availability of seating.

If you did not notify us at the time of registration whether you will be attending any of the included functions it will be assumed that you are not attending and you will not have any tickets in your registration pack. If this has changed and you wish to attend a function please notify the conference staff no later than the day prior to the function. It is not guaranteed that there will be tickets available once onsite.

MEALS

Meals are included in the registration fee and will be served throughout the exhibition area in the Ballroom Foyer during the session breaks from Friday 26 to Monday 29 April. All buffet foods are labelled to identify dietary requirements. If you have noted a specific dietary requirement in your registration, please make yourself known to the banquets team and they will assist you further.

NAME BADGES AND TICKETS

Name badges must be visible and worn at all times within the conference venue for access to the meeting and catering. Event wristbands will be issued in the delegate pack to act as tickets for delegates who have registered to attend the social functions. Wristbands must be worn during the event as they will be held in locations accessible to hotel guests.

MOBILE PHONES

Delegates are kindly requested to keep their mobile phones on silent in the rooms where scientific and educational sessions are being held.

INTERNET ACCESS

Conference Delegates can access free wi-fi internet in the conference areas of the hotel. Access is gained via the password below.

Network: Sofitel Conference
Password: ACP2024

INSURANCE

The Organising Committee of the conference is unable to accept responsibility for accidents or damage to the private property of delegates. Please ensure that you do not leave portable and valuable pieces of equipment unattended anywhere, and that you make your own arrangements for health, travel, general and other insurance.

CPD

You will be provided with a Certificate of Attendance, which will be emailed to all delegates after the conference. Each college has individual requirements on what can be claimed. CPD with other colleges is generally recorded as a self directed activity. Contact your CPD home for information on how they require you to record your activity.

SPEAKERS PREPARATION ROOM

Speakers are asked to bring their formatted PowerPoint presentations to the Speakers Preparation Room the day prior or at least two sessions before their scheduled presentation. Files from thumb drives can be transferred to the servers at that time.

The speakers preparation room is located in Republik opposite the ballroom and will be open as follows:

Friday 26 April	7:00 AM - 2:00 PM
Saturday 27 April	7:00 AM - 1:00 PM
Sunday 28 April	7:00 AM - 1:00 PM
Monday 29 April	8:30 AM - 11:30 PM

REGISTRATION DESK HOURS

The registration desk will be located in the hotel lobby for the duration of the conference.

Friday 26 April	7:00 AM - 2:00 PM
Saturday 27 April	7:30 AM - 2:00 PM
Sunday 28 April	7:30 AM - 2:00 PM
Monday 29 April	9:00 AM - 11:30 AM

Elevating the standards of clinical photography

Our Clinical Imaging System is a customised photography workflow that enables excellence in pre and post image capture, storage and distribution. Designed with efficiency, flexibility and simplicity in mind, each Clinical Imaging System is easily tailored to suit your clinic's specific needs. No photographic knowledge or skill is needed to use the system.



Image courtesy of Dr. Peter Callan



Image courtesy of Dr. Sarah Boxley



Image courtesy of Dr. Alice Rudd



Image courtesy Dr. Steven Liew

How much space is required for a dedicated photo room?

We have installed in all sorts of room dimensions and we confidently recommend a minimum size of 1.2m wide by 2.5m long. Room layouts are customised during the quotation process. All that is needed is a comfortable distance in between the photographer and patient. With our installations, no tripod, umbrellas or floor stands are required.

Demonstrate to your clients that your treatments are working through objective and consistent clinical photography.



Image courtesy of Vamp Cosmetic



Image courtesy of Prof. Greg Goodman



Image courtesy of All Saint Clinic

Packages from \$12,500 ex gst



Scan to book a demo.

Clinical Imaging Australia Pty Ltd.

P. +61 481 174 234 W. clinicalimaging.com.au E. hello@clinicalimaging.com.au

CONFERENCE APP

Delegates are encouraged to download the conference app which includes the program, information, ways to contact your colleagues and the interactive voting app.

Submitted abstracts can also be viewed through the conference app.

Scan the QR code below to gain access.

When accessing the app, use the event code **ACP2024** and be sure to log in using the details you registered with through EventsAIR.

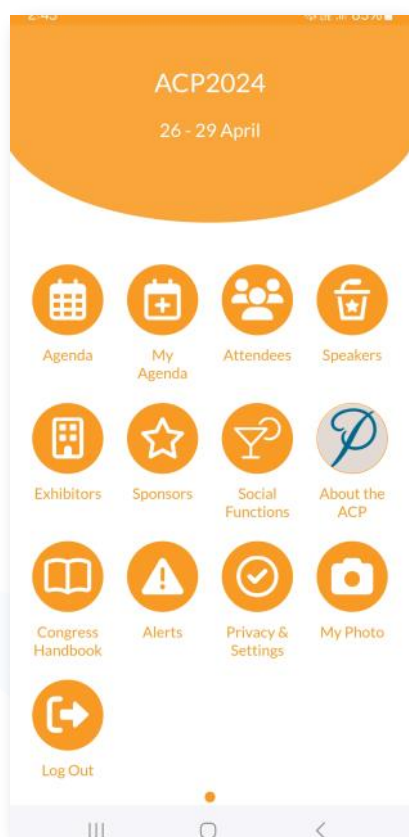

INVITED SPEAKERS



**Dr Christopher Pittman
Phlebologist, USA**

Dr. Pittman is board certified in Diagnostic Radiology, Vascular and Interventional Radiology, and a diplomate of the American Board of Venous and Lymphatic Medicine.

He is CEO and Medical Director of Vein911® Vein Treatment Centers and Managing Director of Health Performance Specialists, the largest independent network of vein care practices in the USA.

An outspoken advocate of foam sclerotherapy, he administers the LinkedIn Group "Foam Sclerotherapy Experts" consisting of 1400+ worldwide physicians; and, is President, TransAmerican Sclerotherapy Institute, Inc., a 501(c)(3) promoting the patient benefits of sclerotherapy and the education of sclerotherapists.

He is Executive Producer of the Vein911 reality show focused on education and outreach for the millions of unaware Americans who suffer from venous disease.

Dr. Pittman is deeply dedicated to physician and patient advocacy with over 30 years local, state, and national medical-political leadership experience including AVLS Board Member; Chair, Healthcare Advocacy Committee; Member, Health Policy Committee; Past Board Member and Secretary, Foundation for Venous and Lymphatic Disease; Past AVLS Alternate Delegate and Delegate, American Medical Association; Past President and Board Member, Florida Medical Association Political Action Committee.

A devoted husband, father of four, and 26-year cancer survivor, he enjoys weight training, outdoor roller-skating, traveling, and health information technology.



**Dr Chris Rogan
Interventional Radiologist,
NSW**

Dr Chris graduated Medicine from the University of NSW in 2002 with First Class Honours and went on to complete RACS basic surgical training prior to advanced training in

radiology at RPA Hospital and subsequently sub-specialisation in image-guided procedures as an interventional radiologist.

After fellowship training at Imperial College London, Chris was awarded the Thomas Baker Travelling Fellowship grant which opened the door to his travelling internationally visiting interventional radiology units across the UK and USA to obtain broad exposure to current best practices. That year, Dr Chris was also awarded European Board of Interventional Radiology certification. Chris obtained extensive endovascular surgery experience during 10 years at RPA hospital as well as obtaining Phlebology fellowship during this time.

In 2021, Dr Chris became President of the Interventional Radiology Society of Australasia and is head of department of Interventional Oncology at Chris O'Brien Lifehouse.

He has special interests in embolization as it applies to conditions including prostate enlargement and knee pain and the treatment of complex venous disease.

FACULTY

Mrs Bronwyn Aberline
 Dr Ali Akhtar
 Dr Francesco Artale
 Dr Rhys Bennett
 Dr Stephen Benson
 Ms Nicole Curtis
 Dr Balram Dhillon
 Dr Joseph Grace
 Dr Karen Hammad
 Dr David Huber
 Dr Harry Jones
 Dr Serge Mako
 Ms Andrea Mangion
 Dr Lisa Marks
 Dr Luke Matar
 Dr Nichole Mellor

Dr Manjunath Nadiger
 Dr Sanjay Nadkarni
 Prof. Kurosh Parsi
 Professor Neil Piller
 Dr Christopher Pittman
 Dr Timoci Qereqeretabue
 Dr Johann Christof Ragg
 Dr Stefania Roberts
 Dr Christopher Rogan
 Dr Phoebe Shearman
 Dr Manisha Siriwardhane
 Dr Paul Thibault
 Prof. Andre Van Rij
 Dr Yunyi Wang
 Mr Woodrow Wilson



No Time for Tired Legs?

SIGVARIS
GROUP



Scan here for
complimentary
travel socks

Travel better with **sigvaris**



PROGRAM AT A GLANCE

	Friday	Saturday	Sunday	Monday
800				
830	Opening Plenaries	Cyanoacrylate Closure	Oedema, Lymphoedema & Lipoedema	
900				
930	Break			
1000	ACP Consensus on Intra-arterial Injections	Debate: <i>Cyanoacrylate Closure</i>	Debate: <i>EVLA vs RFA</i>	New Insights in Phlebology
1030				
1100	Morning Tea			
1130	Sponsored Presentations			
1200				Cases and Clinical Puzzles
1230	Venous Disease	Sclerotherapy	Diagnostic Imaging and Interventional Radiology	
1300				
1330	Lunch			
1400			Endovenous Ablation Workshop	
1430				
1500	Phlebology Training Course (ACP Trainees)	Ultrasound Workshop (ACP Trainees)		
1530				
1600				
1630				
1700				
1730				
1800	Welcome Reception		Conferring Ceremony and Gala Dinner	
Registration	0700 - 1400	0730 - 1400	0730 - 1400	0900 - 1130
Exhibition	0930 - 1400	0930 - 1400	0930 - 1400	
Speaker Room	0700 - 1400	0700 - 1300	0700 - 1300	0830 - 1130

* Program subject to change

FRIDAY 26TH APRIL

OPENING

Chair: Lisa Marks

Moderator: Simon Thibault

- 755 Welcome Address
Lisa Marks, President Australasian College of Phlebology
David Connor, Convenor
- 800 The Future of the Specialty, External Pressures, and the Role of Advocacy
Christopher Pittman
- 820 Should CEAP become PACE?
Johann Christof Ragg
- 830 The Venous Muscle Pump
Andre van Rij
- 840 The World Health Organisation response during the COVID-19 pandemic
Karen Hammad
- 850 The Burden of Venous Disease in Fiji
Ali Akhtar and Timoci Qereqeretabue

905 Panel Discussion

930 Refreshment Break

ACP CONSENSUS ON INTRA-ARTERIAL INJECTIONS

Chair: Peter Paraskevas

Moderator: Adrian Lim

- 1000 Clinical management following actual or suspected inadvertent intra-arterial injection of sclerosants
Kurosh Parsi
- 1030 Panel Discussion

1100 Morning Tea

SPONSORED EDUCATIONAL PRESENTATION

- 1130 Leveraging digital technology to enhance patient centred care
Andrea Mangion
Brought to you by Sigvaris

VENOUS DISEASE

Chair: Andrew Stirling

Moderator: Andre van Rij

- 1200 Superficial Venous Disease: Comprehensive Care of the Entire Patient
Christopher Pittman
- 1220 Bulging Veins in Athletes - what to do?
Andre van Rij
- 1230 Venous insufficiency in children and adolescents: Update on current progression studies
Johann Christof Ragg
- 1240 Venous Incompetence Treatment - effect on restless leg syndrome
Luke Matar
- 1250 Is Edema Underrecognized in Superficial Venous Disease Patients?
Christopher Pittman
- 1300 Should we be treating incompetent perforators?
Sanjay Nadkarni
- 1310 Panel Discussion

FRIDAY 26TH APRIL

1330 Lunch

PHLEBOLOGY TRAINING COURSE (TRAINEES)

1400 Lectures

1500 Break and move to round tables

PHLEBOLOGY TRAINING COURSE - ROUND TABLES (TRAINEES)

1520 Round Table Discussions
20 minutes per table

1700

1800

Welcome Reception



* Program subject to change

SATURDAY 27TH APRIL

CYANOACRYLATE CLOSURE

Chair: Peter Paraskevas

Moderator: Christopher Rogan

- 800 Saphenous Vein Cyanoacrylate Embolisation (CAE) complicated by a delayed chronic inflammatory reaction requiring surgical intervention
Luke Matar
- 810 Formaldehyde as a degradation product of cyanoacrylates
Joseph Grace
- 820 Vein Ablation Trends: Comparing Western Australia's Practices with National Data
Luke Matar
- 830 899 serious adverse events including 13 deaths, 7 strokes, 211 thromboembolic events, and 482 immune reactions: The untold story of cyanoacrylate adhesive closure
Kurosh Parsi
- 900 Panel Discussion

930 Refreshment Break

DEBATE: "THERE IS STILL A PLACE FOR CYANOACRYLATE TREATMENT IN A PHLEBOLOGY PRACTICE"

Chair: Louis Loizou

Moderator: Sanjay Nadkarni

- 1000 FOR: Stefania Roberts
- 1010 AGAINST: Joseph Grace
- 1020 Rebuttals
- 1030 Panel Discussion

1100 Morning Tea

SPONSORED EDUCATIONAL PRESENTATION

- 1130 Post Sclero Staining – How Excel V and Enlighten compliment a Phlebology Clinic
Paul Thibault
Brought to you by Cutera

SCLEROTHERAPY

Chair: Joseph Grace

Moderator: Christopher Pittman

- 1200 How to run, manage and maintain a superficial vein practice
Christopher Pittman
- 1210 Day hospital licensing and accreditation: the current National Safety and Quality Hospital Standards
Lisa Marks
- 1220 Exercise-assisted Foam Sclerotherapy: A safety protocol update
Johann Christof Ragg
- 1230 Foam Sclerotherapy: Tips and Tricks
Christopher Pittman
- 1240 When protocols go wrong
Stephen Benson
- 1250 The importance of good practice and training
Serge Mako
- 1300 Is breastfeeding a true relative contraindication for sclerotherapy?
Phoebe Shearman
- 1310 Panel Discussion

SATURDAY 27TH APRIL

1330 Lunch

ULTRASOUND WORKSHOP

- 1400 How to take a patient history
Stephen Benson
- 1420 How to perform a venous map
Stefania Roberts
- 1440 Visualise Vessels with Unparalleled Clarity
Bronwyn Aberline
Sponsored by Fujifilm Sonosite
- 1510 Ultrasound Stations
Station 1: Stefania Roberts
Station 2: Stephen Benson

1700



**REMEMBER TO CHOOSE YOUR
SEAT FOR THE GALA DINNER
ON THE CHART AT THE
REGISTRATION DESK BY 2PM
SATURDAY 27 APRIL.**



* Program subject to change

SUNDAY 28TH APRIL

OEDEMA, LYMPHOEDEMA AND LIPOEDEMA

Chair: Neil Piller

Moderator: David Connor

- 800 Making a difference to oedema/lymphoedemas in mobile and immobile patients with venous and lymphatic drainage function issues with electro-stimulation?
Neil Piller
- 820 How do Phlebolymphoedema Patients Benefit from Venous Treatment and Post Treatment Compression
Christopher Pittman
- 830 Understanding the impact of temperature changes on lymphoedema
Neil Piller
- 840 Quantative Measurement of Pitting Edema with a Novel Edema Ruler
Christopher Pittman
- 850 The Utilisation of eHealth in Lymphoedema Care
Andrea Mangion
- 900 Once seen never forgotten: Sub Echogenicity Grading Of Lymphoedema in Lipoedema Patients
Rhys Bennett
- 910 Panel Discussion

930 Refreshment Break

DEBATE: "ENDOVENOUS LASER ABLATION VERSUS RADIOFREQUENCY ABLATION"

Chair: Louis Loizou

Moderator: Kurosh Parsi

- 1000 FOR Endovenous Laser Ablation - Stefania Roberts
"Versatility and maneuverability of laser fibers versus stiffer and thicker RFA devices - which would you choose?"
- 1010 FOR Radiofrequency Ablation - Steve Benson
"Laser is cool (not), but radio is better"
- 1020 Rebuttals
- 1030 Panel Discussion

1100 Morning Tea

SUNDAY 28TH APRIL

SPONSORED EDUCATIONAL PRESENTATION

- 1130 Clinical Photography - Why you need to take it seriously for your clinic, patients and business
Woodrow Wilson
Brought to you by Clinical Imaging Australia

DIAGNOSTIC IMAGING AND INTERVENTIONAL RADIOLOGY

Chair: Kurosh Parsi

Moderator: Luke Matar (TBC)

- 1200 Radiology versus Histology: misdiagnosis of malignant tumours as vascular anomalies
Manisha Siriwardhane
- 1210 What's this? An interactive Quiz
Kurosh Parsi
- 1240 Embolisation Principles: a review of embolic agents
Christopher Rogan
- 1250 The SVP Classification for Pelvic Venous Incompetence
Sanjay Nadkarni
- 1300 Pelvic Venous Disorders
Christopher Rogan
- 1310 Panel Discussion

1330 Lunch

ENDOVENOUS ABLATION

- 1400 Endovenous Laser Ablation
Stefania Roberts
Brought to you by Device Consulting
- Radiofrequency Ablation
Stephen Benson
Brought to you by Medtronic

1530

1700 Pre Ceremony Drinks
Ceremony Gowning for ACP Academic Procession and Fellowship Recipients

1730

Conferring Ceremony - Main Ballroom
and
Gala Dinner - Private Beachside Location

* Program subject to change

Conferring Ceremony

All delegates and exhibitors are invited to attend the Annual Conferring Ceremony and Gala Dinner which will be held in the Ballroom at the Sofitel Fiji. This is an evening of tradition where distinguished members of the Phlebological community and related fields are recognised for their efforts and contribution to the field of Phlebology. This is also the evening where new College Fellows are awarded their Fellowships and the College trainees are awarded their graduation certificates for successful completion of the College training program. Please come along and show your support for our esteemed guests and emerging phlebologists.

Sunday 28th April 5.00 pm

Ballroom, Sofitel Fiji



NEW INSIGHTS IN PHLEBOLOGY

Chair: Paul Thibault

Moderator: David Huber

- 920 A case of Loeys-Dietz syndrome presenting with CVI
Harry Jones
- 930 Prototype for an implantable calf pump
David Huber
- 940 Increased Incidence of Superficial Venous Thrombosis (SVT) in Varicose Vein Patients in the Post-COVID Era
Luke Matar
- 950 Diagnosis of Post-Thrombotic Syndrome: Survey of Medical Specialists
Manisha Siriwardhane
- 1000 Hyaluronan immersion technique (HIT) for precise, volume-saving and fast shaping of vein lumina and valve zones
Johann Christof Ragg
- 1010 Ultrasound Guided Foam Sclerotherapy of Venous Leak Induced Erectile Dysfunction
Christopher Pittman
- 1020 Association of Surgical Stripping (SS) with the Radiofrequency Ablation (RFA) of the great saphenous vein (GSV) for a better aesthetic result.
Francesco Artale
- 1030 Cerebrospinal Venous Obstruction associated with Breast Cancer
Paul Thibault
- 1040 Panel Discussion

1100 Morning Tea

CASES AND CLINICAL PUZZLES

Chair: Lucy McKinnon

Moderator: Manisha Siriwardhane

- 1130 A mysterious lump in the groin
Nicole Curtis
- 1140 Rosacea - a chronic infective venous vasculitis of the head and neck
Paul Thibault
- 1150 Sciatic neuropathy following radiofrequency endovenous ablation treatment for varicose veins: A case report and systematic review
Yunyi Wang
- 1200 KTS: A lived experience
Balram Dhillon
- 1210 Pelvic Congestion Syndrome - A case study
Nicole Mellor
- 1220 Recurrent bilateral lower limb varicose veins in a young adult
Manjunath Nadiger
- 1230 Non-healing ulcers: treat the venous disease.
Manisha Siriwardhane
- 1240 Panel Discussion

1320 ACP2024 Closing

GALA DINNER

A Night
in the
Tropics

28.04.

ARRIVE 17:00
FOR DRINKS
SOFITEL BALLROOM

PRIVATE BEACH LOCATION
TRADITIONAL FIJIAN ENTERTAINMENT
LOCAL BAND

TICKETS REQUIRED

EXHIBITORS

The Australasian College of Phlebology would like to extend its appreciation to all of our sponsors and exhibitors. Without their continued support we would not be able to bring our meetings to you year after year.

Their innovative products, services, and contributions have enriched our experience and fostered a vibrant atmosphere for collaboration and knowledge exchange.

Be sure to visit our exhibitors during meal breaks, they are eager to touch base with you.

BOOTH LISTING

EXHIBITOR	BOOTH	EXHIBITOR	BOOTH
Sigvaris	1	Clarius / Lateral Medical	4
Cutera	2	Medtronic	5
Fujifilm Sonosite	3		

EXHIBITORS

Clarius / Lateral Medical

Booth 4

Elevate your phlebology practice with Clarius ultrasound. Our wireless devices streamline venous assessments, offering high-definition imaging for accurate diagnoses and interventions. Visit our booth to discover how Clarius handheld ultrasound can simplify procedures, reduce complications and improve outcomes. Clarius products are made in Canada and distributed in Australia by Lateral Medical.

Lateral Medical is an Australian-owned company that specialises in being a clinician-first organisation. We work closely with our users to source and develop innovative solutions based on the unique needs of the healthcare community. We are an ISO9001 accredited company with an extensive network of product specialists providing education, sales and support throughout Australia & New Zealand.



Annabel Dominguez

0493 583 988



Annabel.dominguez@clarius.com



<https://clarius.com/>



clarius
Ultrasound Anywhere



Cutera ANZ

Booth 2

Cutera was founded in 1998 by veteran laser and optical engineers who envisioned that technology should and could do more. We have since grown into a global leader of dermatology and aesthetics devices that appeal to forward-thinking clinicians who seek the next generation of performance, safety, and efficacy.



Helen Tudehope

0417 359 820



htudehope@cutera.com



www.cutera.com

CUTERA®

A New Energy in Aesthetics

Fujifilm Sonosite

Booth 3

FUJIFILM Sonosite, Inc, the world leader in bedside and point-of-care ultrasound (POCUS), delivers solutions that meet the imaging needs of the medical community. Headquartered near Seattle, the company is represented by a global distribution network in over 100 countries.

As a recognized market leader, Sonosite continues to earn worldwide recognition for its innovative product line, educational programs, and advocacy for a broader understanding of ultrasound's many benefit .



Bronwyn Aberline / Veronika Kubacka

0400 446 254 / 0412 140 992



bronwyn.aberline@fujifilm.com/

veronika.kubacka@fujifilm.com



www.sonosite.com/au

FUJIFILM
SONOSITE

Medtronic Booth 5

Bold thinking. Bolder actions. **We are Medtronic.**

We lead global healthcare technology and boldly attack the most challenging health problems facing humanity by searching out and finding solutions. Our Mission — to alleviate pain, restore health, and extend life — unites a global team of 95,000+ passionate people.

Powered by our diverse knowledge, insatiable curiosity, and desire to help all those who need it, we deliver innovative technologies that transform the lives of two people every second, every hour, every day. Expect more from us as we empower insight-driven care, experiences that put people first, and better outcomes for our world. In everything we do, we are engineering the extraordinary.



James Chiou

0421 354 709



james.chiou@medtronic.com



www.medtronic.com/au-en/index.html



Sigvaris Group Booth 1

SIGVARIS GROUP is 100% family-owned, it was founded in 1864 in Winterthur by Moritz Ganzoni-Sträuli, the company collaborated with the phlebologist Dr. Karl Sigg and developed a medical compression stocking to improve venous function and relieve venous-related conditions.

Today, SIGVARIS GROUP is committed to helping people feel their best with high-quality and innovative offerings in medical compression therapy. Every day. Worldwide. Our portfolio caters to a wide range of different needs and indications.



Damien Peak

0474 482 888



damien.peak@sigvaris.com

marketing.au@sigvaris.com



www.sigvaris.com





ACP2025
GOLDCOAST
AUSTRALIA

9 - 12 MAY 2025



SPONSORS AND EXHIBITORS

The ACP would like to thank all of our sponsors and exhibitors for their continued support of our Annual Scientific Meeting.



MAJOR PARTNER



